

ALLDAY
& MILLER



Evergreen Way, Hayes, UB3 2BH
£270,000

 2  1  1  C



Evergreen Way, Hayes, UB3 2BH

£270,000

- Two Double Bedrooms
- Long Lease Remaining
- Close To Hayes & Harlington Station
- Garage
- Cul De Sac
- Chain Free
- Great For Investment
- 543 Sq Ft
- Close To Amenities
- Separate Kitchen

Description

Set in a stunning residential development this apartment on offer comprises of an entrance hall leading into the generously sized reception/ dining room filled with ample of natural light , also giving access to the fitted kitchen, two double bedrooms and to finish with a bathroom suite.

The property benefits from a residents parking space, attractive communal gardens and a security entrance system.

Situation

Evergreen Way is a popular residential Cul-De-Sac located in the heart of Hayes. Hayes and Harlington station within a close proximity giving quick access links to Central London. Stockley Business Park, Heathrow Airport & the M4/M25 Motorways are also within a short drive. Uxbridge Town centre being a 16 minute journey away with an array of restaurants, coffee shops, bars and shopping centres. There are also a number of highly regarded schools including Hayes Park primary school and Grange Park.



Floor Plans

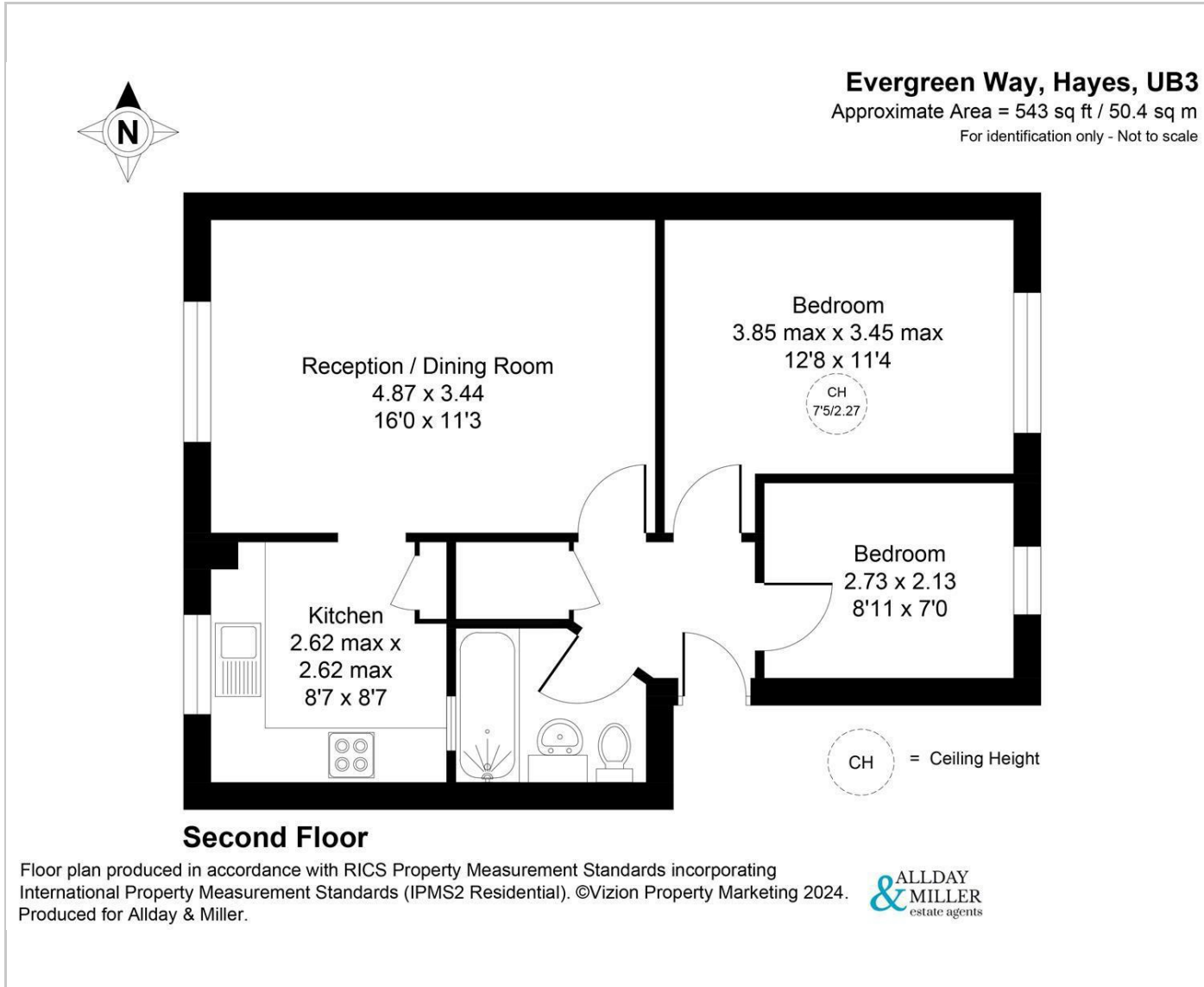

Area Map

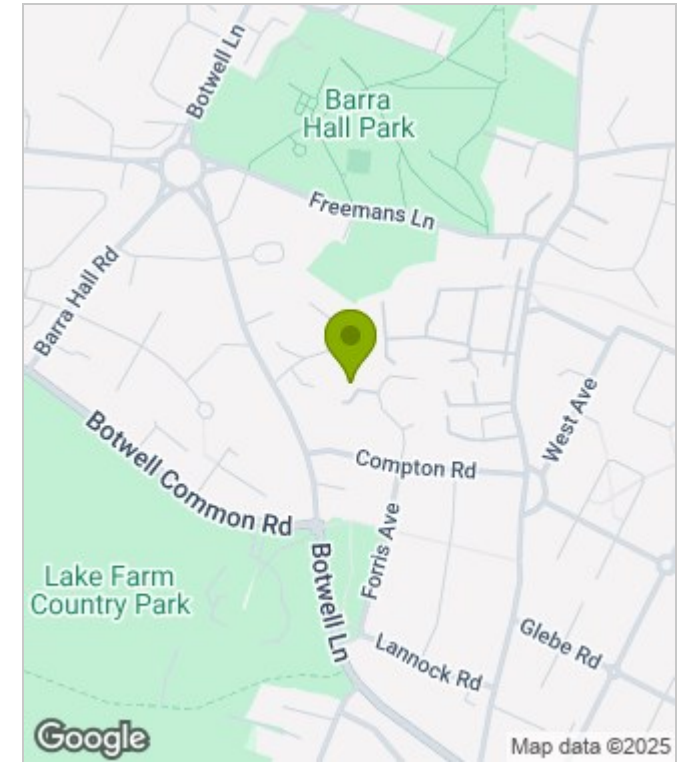

Energy Performance Graph

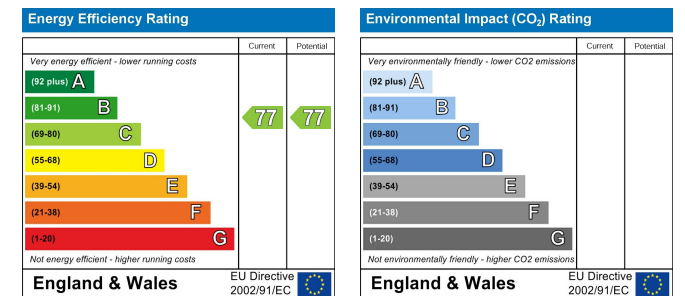

These particulars, whilst believed to be accurate are set out as a general outline only for guidance and do not constitute any part of an offer or contract. Intending purchasers should not rely on them as statements of representation of fact, but must satisfy themselves by inspection or otherwise as to their accuracy. No person in this firm's employment has the authority to make or give any representation or warranty in respect of the property.